

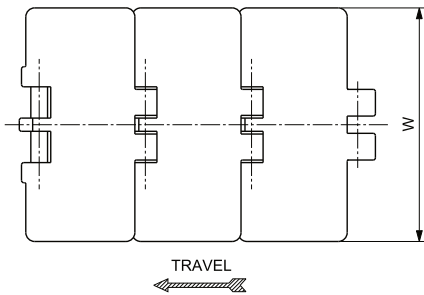

Straight Running Plastic Chain - 820 Series

SINGLE HINGE
PITCH 1 1/2"(38,1 mm)
THICKNESS 4 mm (0.157")
HINGE 41,6 mm (1.638")

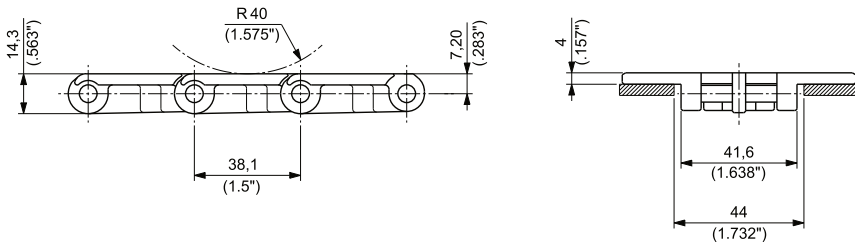

Materials
see page 12



Sprockets
see pages 141+144



Applications
see page 22

MATERIALS		ITEM DESCRIPTION	PART NUMBER	WIDTH W		PLATE THICKNESS		WORKINGLOAD (25°C/77°F)		WEIGHT	
Plate	Pin			mm	inch	mm	inch	N	lbs	kg/m	lbs/ft
ULTRA PERFORMANCE HOMOPOLYMERDELRIN® UP	AUSTENITIC STAINLESS STEEL	UP 820 K 3 1/4	UP820KD/000	82,6	3.25	4,0	0.16	1600	360	0,87	0.58
		UP 820 K 83,8	UP820KRA/000	83,8	3.30	4,0	0.16	1600	360	0,88	0.59
		UP 820 K 4	UP820KF/000	101,6	4.00	4,0	0.16	1600	360	0,95	0.64
		UP 820 K 4 1/2	UP820KG/000	114,3	4.50	4,0	0.16	1600	360	1,03	0.69
		UP 820 K 6	UP820KH/000	152,4	6.00	4,0	0.16	1600	360	1,25	0.84
		UP 820 K 7 1/2	UP820KL/000	190,5	7.50	4,0	0.16	1600	360	1,35	0.90
SPECIAL DELRIN® REINFORCED WITH KEVLAR® DK2™	AUSTENITIC STAINLESS STEEL	D2K 820 K 3 1/4	D2K820KD/000	82,6	3.25	4,0	0.16	1600	360	0,85	0.57
		D2K 820 K 83,8	D2K820KRA/000	83,8	3.30	4,0	0.16	1600	360	0,86	0.58
		D2K 820 K 4 1/2	D2K820KG/000	114,3	4.50	4,0	0.16	1600	360	1,00	0.67
		D2K 820 K 7 1/2	D2K820KL/000	190,5	7.50	4,0	0.16	1600	360	1,36	0.90
NEW ECOLOGICAL FRICTION ABATING THERMOPLASTIC E-FAST.	AUSTENITIC STAINLESS STEEL	EF820 K 3 1/4	EF820KD/000	82,6	3.25	4,0	0.16	1600	360	0,85	0.57
		EF820 K 83,8	EF820KRA/000	83,8	3.30	4,0	0.16	1600	360	0,86	0.58
		EF820 K 4 1/2	EF820KG/000	114,3	4.50	4,0	0.16	1600	360	1,00	0.67
ABRASION RESISTANT POLYAMIDE(1) AR	AUSTENITIC STAINLESS STEEL	AR820 K 3 1/4	AR820KD/000	82,6	3.25	4,0	0.16	1600	360	0,85	0.57
		AR820 K 4 1/2	AR820KG/000	114,3	4.50	4,0	0.16	1600	360	0,98	0.66

(1)ACTUAL WIDTH CAN BE UP TO 0,5% GREATER THAN NOMINAL WIDTH



Standard packaging:
Rolls of 3,048 m (10 feet)